

## HOOKS

Fry Technology can be provided with ends that are drilled and tapped or have hooks burnt onto the anode. Cast anodes have the option of nuts being casted in one end.

CONDUCTOR BAR CAPACITIES

Hook No.	Length	Round		Square		Rectangle	
		Min	Max	Min	Max	Min	Max
R2	3-7/16"	3/4"	1-1/2"	1/2"	1/8"	---	---
R6	4-5/8"	3/4"	2"	1/2"	1-1/2"	---	---
R7	6-1/8"	1-5/8"	2"	1"	1-1/2"	1x2-1/4"	1-1/4 x1-7/8"
R10	5-1/4"	--	--	3/4"	2-1/4"	3/8 x 3-1/2"	1-1/2" x3
R11	5-3/4"	2"	2-1/4"	1"	1-3/4"	1x2-1/2"	1-1/2"x2"
R12	6-1/4"	1/2"	7/8"	---	---	3/4x2-3/4"	3/4 x 2-1/8"

CONDUCTOR BAR CAPACITIES

Hook No.	Length	Round		Square		Rectangle	
		Min	Max	Min	Max	Min	Max
1	4-1/2"	1-1/8"	1-1/2"	5/8"	1"	---	---
2	5-1/2"	3/4"	2"	5/8"	1-1/2"	---	---
4	6"	1/2"	1"	1/2"	1"	1/2x2-1/2"	1x2"
41	3-1/4"	1/2"	1-1/2"	1/2"	1"	---	---

### For Round Anodes-double edged

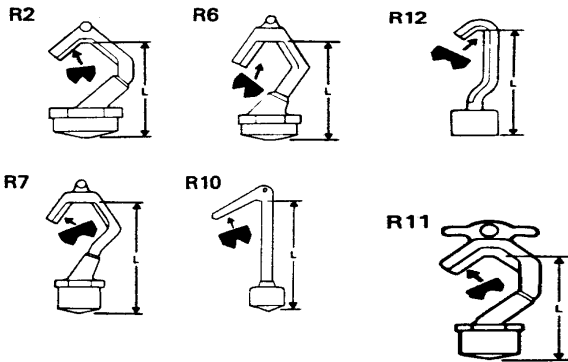

### For Flat & Shaped Anodes

